

Bach To The Future

Technical Information

(July 2011 – Please destroy all previous versions)

Stage set-up and Props

- 1) A stage diagram is enclosed. Orchestra should be set-up as for any symphony concert however allow for 12 feet of space between the conductor's podium and the front of the stage for the actors. (See stage diagram)
- 2) The following props must be provided:
 - An old-looking plain wooden desk or table and matching chair. Not fancy, for a poor Mozart to compose at. Period furniture is ideal but plain wooden furniture is acceptable.
 - A small, low, wooden stool. (Could match Mozart furniture but not absolutely necessary.)
 - Steps from the house onto the stage at SL.
 - A large prop table backstage SR with mirror and light.
- 3) Platypus Theatre will provide the flat shown in the stage diagram. **N.B. Because of the position of the flat, spectators sitting directly next to the apron on SR will have a restricted view during the first 15 minutes of the concert. (See stage diagram)**

Lighting Requirements

There are approximately 44 lighting cues which need to be programmed by the facility's lighting director and the company technical director prior to the dress rehearsal. Programming of cues can be done in 1.5 hours with an experienced board operator and a computerized board if lights have been hung and focused in advance based on the following information.

- 1) Standard concert wash. This should be a warm amber (R04) or pink (R35). If possible, should include apron where the actors perform.
- 2) Apron washes. This must cover the area across the stage in front of the podium where the actors perform in a pale amber and blue. The wash should be divided into 5 area specials. (see stage diagram)
- 3) Blue orchestra wash (R81).
- 4) A colour chase on the back wall to simulate time travel.
- 5) Music stand lights on a separate circuit to allow for stage black-out.
- 6) At least two lamps to project pin-point star gobos on back wall (Gobos provided by Platypus Theatre).
- 7) Conductor Special.
- 8) Special SR (see diagram)

Sound Requirements

- 1) Two clip-on wireless microphones. (Must be provided by orchestra)
- 2) Small mixing console, speakers suitable to the performance space.
- 3) Conductor monitor.
- 4) Technician to operate sound board.

Please refer any technical questions to Peter Duschenes

phone: (613) 792-1250

email: peter@platypustheatre.com • website: www.platypustheatre.com

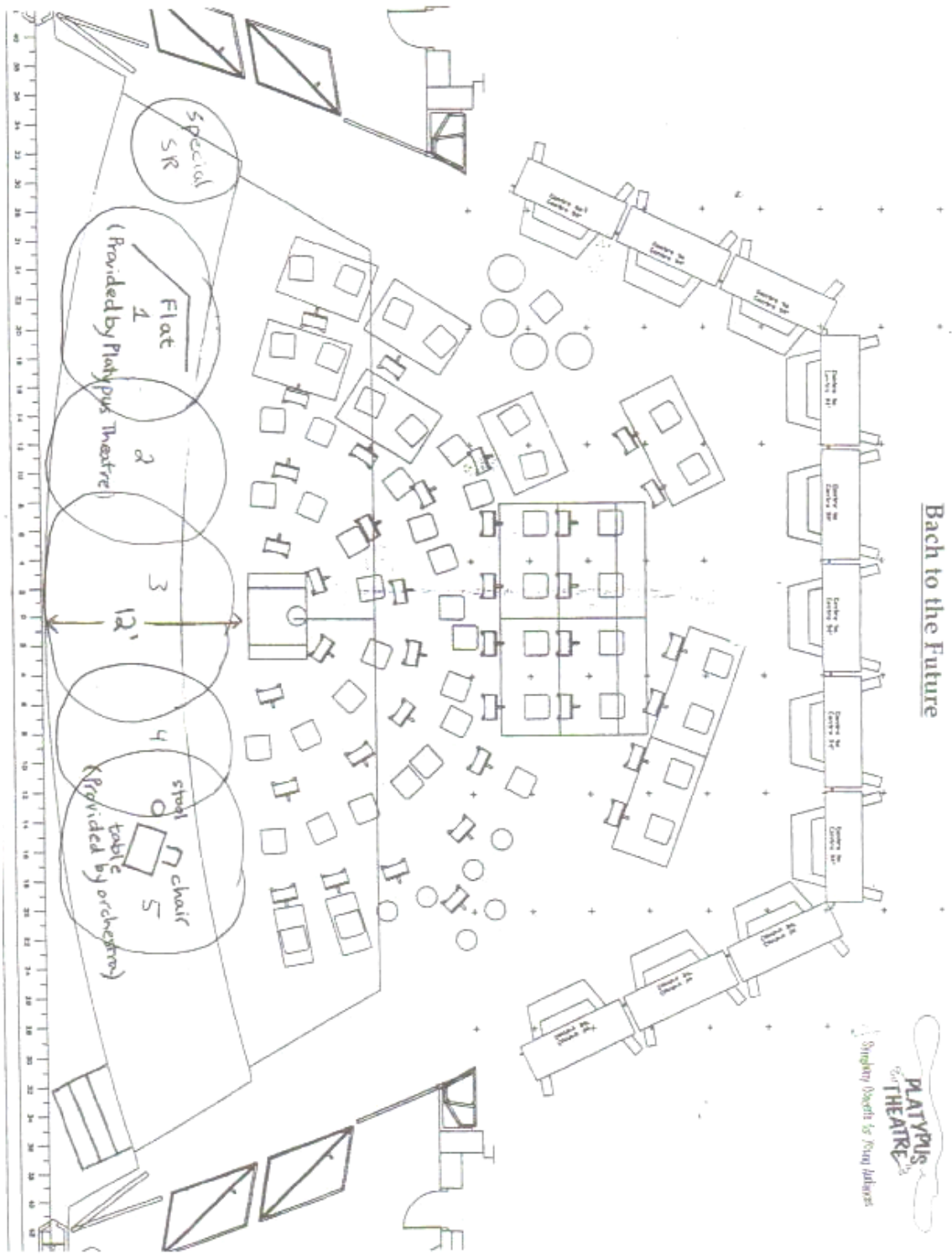

Back to the Future

